

Hamilton Beach

— C O M M E R C I A L —

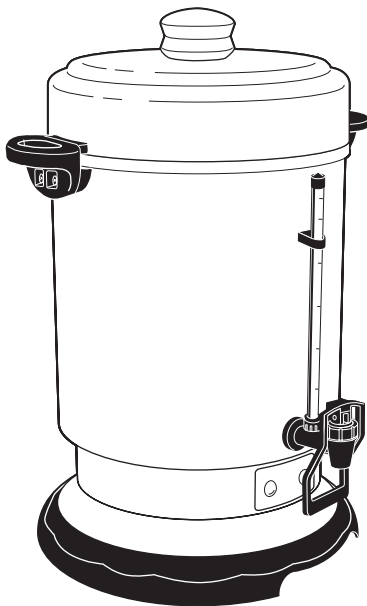

English 2

Français 9

⚠️ WARNING

Shock Hazard

- Do not immerse this appliance in water or other liquid.
- If the plug on this appliance does not fit in your outlet:
 - Do not modify the plug.
 - Do not use an adaptor.
 - Have an electrician replace the obsolete outlet.

IMPORTANT SAFEGUARDS

When using electrical appliances, basic safety precautions should always be followed to reduce the risk of fire, electric shock, and/or injury to persons, including the following:

1. Read all instructions.
2. Do not touch hot surfaces. Use handles or knobs. Care must be taken, as burns can occur from touching hot parts or from spilled, hot liquid.
3. To protect against fire, electric shock, and injury to persons do not place cord, plug or coffee urn in water or other liquid.
4. Close supervision is necessary when any appliance is used by or near children.
5. Unplug from outlet when either the coffee urn is not in use and before cleaning. Allow to cool before putting on or taking off parts and before cleaning the appliance.
6. Coffee urn must be operated on a flat surface away from the edge of counter to prevent accidental tipping.
7. Do not operate any appliance with a damaged cord or plug, or after the appliance malfunctions or is dropped or damaged in any manner. Call our toll-free customer service number for information on examination, repair, or adjustment.

8. The use of accessory attachments not recommended by Hamilton Beach Commercial, Inc. may result in fire, electrical shock or personal injury.
9. Do not use outdoors.
10. Do not let cord hang over edge of table or counter or touch hot surfaces, including stove.
11. Be certain cover is securely in place during brew cycle and when serving coffee.
12. Scalding may occur if cover is removed during brew cycle.
13. Do not place coffee urn on or near a hot gas or electric burner or in a heated oven.
14. Warning: To reduce the risk of fire or electric shock, do not remove the bottom cover. No user serviceable parts are inside. Repair should be done by authorized service personnel only.
15. Do not use appliance for other than intended use.

SAVE THESE INSTRUCTIONS!

CONSUMER SAFETY INFORMATION

This appliance is intended for commercial use.

To avoid an electrical circuit overload, do not use a high wattage appliance on the same circuit with your coffee urn.

This appliance has a short cord to reduce the hazards of becoming entangled or tripping over a longer cord. A grounded-type 3-wire extension cord (3-prong plug) may be used if the electrical rating of the extension cord is greater than the rating of the coffee urn. Care must be taken to arrange the extension cord so that it will not drape over the countertop or tabletop where it can be pulled on by children or tripped over.

Parts and Features

1. Cover with Knob
2. Locking Tabs
3. Spreader
4. Coffee Basket
5. Pump Tube
6. Spring
7. Water Level Indicator
8. Washer
9. Heat Well
10. Serving Spout
11. Power Light
12. Ready Light
13. Cup Trip Handle

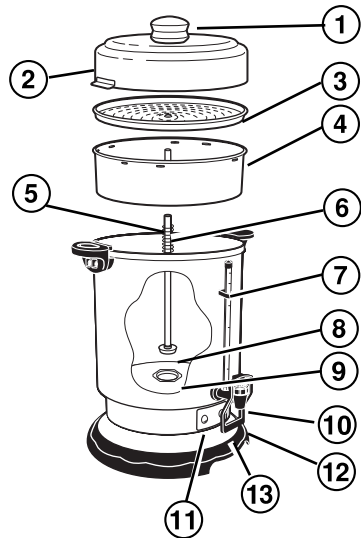

To Make Coffee

Before First Use: Clean the coffee urn by following the steps in “How To Clean.”

1. To remove the cover, grasp the knob and turn counterclockwise until the locking tabs completely clear the handles on each side of the body, then lift up. Take out the basket, spreader, and tube assembly. For best results, always fill with cold, fresh tap water to the level indicator mark inside the body for the number of cups desired. Your coffee urn makes 20–60 cups of coffee. **Always make at least 20 cups.** NOTE: The maximum capacity is 60 cups. **DO NOT OVERFILL THE COFFEE URN.**

2. Wet the basket (this helps to keep small particles of coffee grinds from sifting through). Use a standard dry measure cup and tablespoon to add regular or percolator grind coffee to the basket. The chart on page 6 suggests the amount of coffee for regular brew. The amount of coffee can be varied to suit your taste; use less for weaker coffee or more for stronger coffee.
3. Making sure the spring is on the pump tube, place the basket on the pump tube and cover with spreader. Then, holding the top of the pump tube, lower it into the coffee urn until the bottom of the pump tube is properly seated in the heat well in the center (if not, the coffee urn may not percolate).
4. Place the cover on the body of the coffee urn so that the locking tabs are at the front and back of the coffee urn.
5. Holding the knob, turn the cover clockwise until the locking tabs are fully engaged inside the handles on both sides of the coffee urn. **Never** plug in the coffee urn without the cover in place and the locking tabs fully engaged inside the handles.
6. Plug the coffee urn into a grounded 3-prong 120 V AC wall outlet. The red (ON) light will illuminate and coffee brewing will begin within seconds.

Do NOT plug in the coffee urn when there is no water or liquid inside.

7. When the brewing cycle is complete, percolation stops and the green READY light illuminates to indicate the coffee is ready to serve. The coffee urn automatically switches to the Keep Warm cycle, and will maintain fresh, hot coffee until it is unplugged. If brewed coffee is to be kept warm for a long period of time, the basket, spreader, and pump tube should be removed as soon as brewing is complete. This will prevent bitter oils in the coffee grounds from affecting the flavor of the coffee.

CAUTION: The knob and other parts of the coffee urn will be HOT. Use a pot holder or oven mitt to remove the cover.

8. Disconnect plug from wall outlet and allow the coffee urn to cool before washing.

NOTES:

- **To make additional coffee**, rinse the coffee urn and parts with cold water and repeat steps 1 through 7.
- **To reheat coffee**, remove the basket, spreader, and pump tube. Lock the cover in place and plug in the unit for 20 to 60 minutes, depending on the amount of coffee remaining. Do not reheat if less than 20 cups are left in the coffee urn.

Coffee Making Chart

Water Level	Amount of Ground Coffee
60 cups	3 $\frac{2}{3}$ – 3 $\frac{3}{4}$ cups
50 cups	3 – 3 $\frac{1}{4}$ cups
40 cups	2 $\frac{1}{3}$ – 2 $\frac{1}{2}$ cups
30 cups	1 $\frac{3}{4}$ – 2 cups
20 cups	1 cup + 1 tbsp. – 1 $\frac{1}{3}$ cups

NOTE: We recommend using coffee that has been ground specifically for use in a **percolator-type** coffee maker. However, coffee marked “For All Coffee Makers” is acceptable. If using a coffee grinder and whole beans, percolator coffee should be a coarse grind. A finely ground coffee may cause the coffee basket to overflow and result in grounds in coffee.

How To Clean

1. After each use and before washing, unplug power cord from wall outlet and allow the unit to cool.
2. Carefully remove cover and all internal parts – parts, coffee grounds, and remaining coffee which may still be hot.
3. Wash the inside of the coffee urn and the parts with warm, soapy water. Do NOT immerse the base of the coffee urn in water. The pump tube (with spring), basket, spreader, and cover can be washed in a dishwasher. When washing the pump tube, make sure the washer on the bottom remains loose. If coffee grounds are trapped in this area, hold the pump tube under running water or use a wooden toothpick to remove them.
4. Wipe the outside of the coffee urn with a damp cloth and dry with a towel. Store the coffee urn with the cover off.
5. After repeated use, there may be some coffee stains and accumulation of oils that can cause a bitter taste. Periodically use a coffee-stain remover or special cleanser and follow package directions for cleaning. Rinse well after cleaning. Do NOT use abrasive cleaners or pads on any part of the coffee urn.

Product Warranty

This Warranty Supersedes All Other Product Warranties

LIMITED WARRANTY

This product is warranted to be free from defects in material and workmanship for a period of one (1) year from the date of original purchase, except as noted below. During this period, we will repair or replace this product, at our option, at no cost to you. THE FOREGOING WARRANTY IS IN LIEU OF ANY OTHER WARRANTY, WHETHER EXPRESS OR IMPLIED, WRITTEN OR ORAL INCLUDING ANY WARRANTY OF MERCHANTABILITY OR FITNESS FOR A PARTICULAR PURPOSE, ANY LIABILITY IS EXPRESSLY LIMITED TO AN AMOUNT EQUAL TO THE PURCHASE PRICE PAID, AND ALL CLAIMS FOR SPECIAL, INCIDENTAL AND CONSEQUENTIAL DAMAGES ARE HEREBY EXCLUDED. There is no warranty with respect to the following, which may be supplied with this product: (motor brushes, container and cutter assembly, clutches, bristle brushes, funnel, stainless steel cup, agitators, carafes, etc.). This warranty extends only to the original purchaser and does not cover a defect resulting from abuse, misuse, neglect, unauthorized repair, or use not in conformity with the printed directions. Always use this product in the manner provided in the Operation Manual. This warranty gives you specific legal rights and you may also have other legal rights which vary from state to state, or province to province. Some states do not allow limitations on implied warranties or special, incidental or consequential damages, so the foregoing limitations may not apply to you.

If you have a claim under this warranty please contact our **CUSTOMER SERVICE DEPARTMENT 1-866-285-1087**. (For faster service please have model, series, and type numbers ready for operator to assist you.) Reasonable proof of date of purchase must be presented; otherwise the effective date of the warranty will be based upon the date of manufacture plus ninety (90) days.

Hamilton Beach Commercial
Customer Service
263 Yadkin Road
Southern Pines, NC 28387